

CAROMA CONTURA II - TOWER BASIN MIXER

WATER EFFICIENT TAPWARE

PLUMBERS INSTALLATION INSTRUCTIONS

Important Information

- * **Not suitable for gravity feed systems.**
- * **Mixer is fitted with a flow regulated aerator insert (24).** This low flow rate may not be suitable for connection to some Instantaneous Gas Water Heaters, some Tempering Valves, some Solar Water Heaters & some Thermostatic Mixing Valves. Check with the manufacturers of these products.
- * **Isolating stop taps must be fitted to the hot & cold water supply connections.** (Part No. 842018C - Mini cistern 1/4T)
- * **All pipework must be thoroughly flushed prior to installation, as foreign materials may block the flow regulating device and reduce the flow of water.**
Note: Aerator insert must be retightened to prevent removal by hand.

Installation

- 1) From fixing pack fit 'O'ring (13) into groove in base ring (12). Slide the base ring (12) over the threaded tube (18), align dowel pin at underside of body (11) with the hole at base ring (12) & locate spigot of base ring (12) into base of mixer body (11), as shown in Fig. 1.
- 2) **Flexible Tail Mixer Connections:** Apply suitable lubricant to 'O'rings (19). Fit flexible tail (21) (with red indication) into extended tail (23) marked with a Red Dot. Hand tighten the tail, ensuring the 'O'ring (19) has fully entered the sealing bore to provide a watertight joint. Fit other flexible tail (with blue indication) into remaining extended tail (23) in a similar manner.
- 3) Insert the inlet connection end (22) of each flexible tail (21) through the hole in the deck. Place mixer into deck hole, fit washer (14) followed by fixing plate (15) over threaded tube (18) then screw the fixing nut (16) followed by tightening the fixing screws (17) until the mixer body is secure.
- 4) **Flexible Tail Inlet Connections:** Connect the flexible tails (21) to the hot and cold isolating stop taps, hand tighten the fixing nut (22) until rubber cone contacts the sealing face of the connection end, then tighten a further one turn to provide a watertight joint.
Important: Flexible tails must not be kinked, twisted or in tension when installed. (Minimum Bend Radius:- 50mm)
Do not install flexible tails where subject to ultra violet light.

IMPORTANT	
<ul style="list-style-type: none"> • This product complies with the Lead free requirements of the National Construction Code Volume Three • Hot and cold water inlet pressures should be equal. • Static inlet pressure range : 150-1000 kPa New Regulation:- 500 kPa maximum static pressure at any outlet within a building. (Ref. AS/NZS 3500.1) • Maximum hot water temperature : 80°C. 	
Deck Requirements	
<ul style="list-style-type: none"> • Deck thickness : 40mm maximum • Tap body hole (in deck) : Ø34-36mm 	

Replacing Cartridge

- 1) Turn off hot and cold water supplies.
- 2) Carefully remove plug (4). The 2.5mm allen key (5) can be inserted in the gap under the handle to push out the plug (4) then to loosen grub screw (2) before removing handle (1). Remove plastic insert (6) then extract swivel cap (7) and thrust washer (8) from the mixer body (11), taking care not to damage the decorative finish. **Hint:** The small end of the allen key (5) can be inserted into the slot in the swivel cap (7) and used to lever the cap vertically to remove. Using a 26mm socket, unscrew nut (9) then lift out old cartridge (10).
- 3) Ensure inside face of mixer body (11) is clean. Check that seals are in position in base of new cartridge (10). Fit new cartridge (10) into mixer body (11), taking care that two lugs on base of cartridge (10) fit into mating holes in mixer body (11).
- 4) Screw on nut (9). **Important:** Nut (9) should be tightened to a torque of 7.5 Nm.
- 5) Clean all contact surfaces of swivel cap (7), 'O'-ring and thrust washer (8), ensure they are clean and free from any debris. Lubricate the thrust washer (8), underside of cap (7) and 'O'-ring then fit the thrust washer (8) around the nut (9). Ensure that the cartridge stem is in closed position with the flats on the stem orientated square with the outlet. Fit the swivel cap (7) along with 'O'-ring into the mixer body (11) and ensure the swivel cap cut-out is positioned as shown in **Fig.2**. Fit the insert (6) over the cartridge (10) stem and push it down. Fit handle (1) taking care that it is pushed fully onto insert (6), then tighten grub screw (2). Fit plug (4) along with 'O'-ring (3) taking care not to damage the decorative finish.
- 6) Turn on water supplies and check operation.

Removing Aerator Insert

- 1) Aerator insert (24) can be removed with the key (25) provided.
- 2) Deposits of lime can be removed by washing in a vinegar solution.
- 3) Screw new aerator insert (24) into mixer body (11) and tighten securely with the key (25) (to prevent removal by hand).

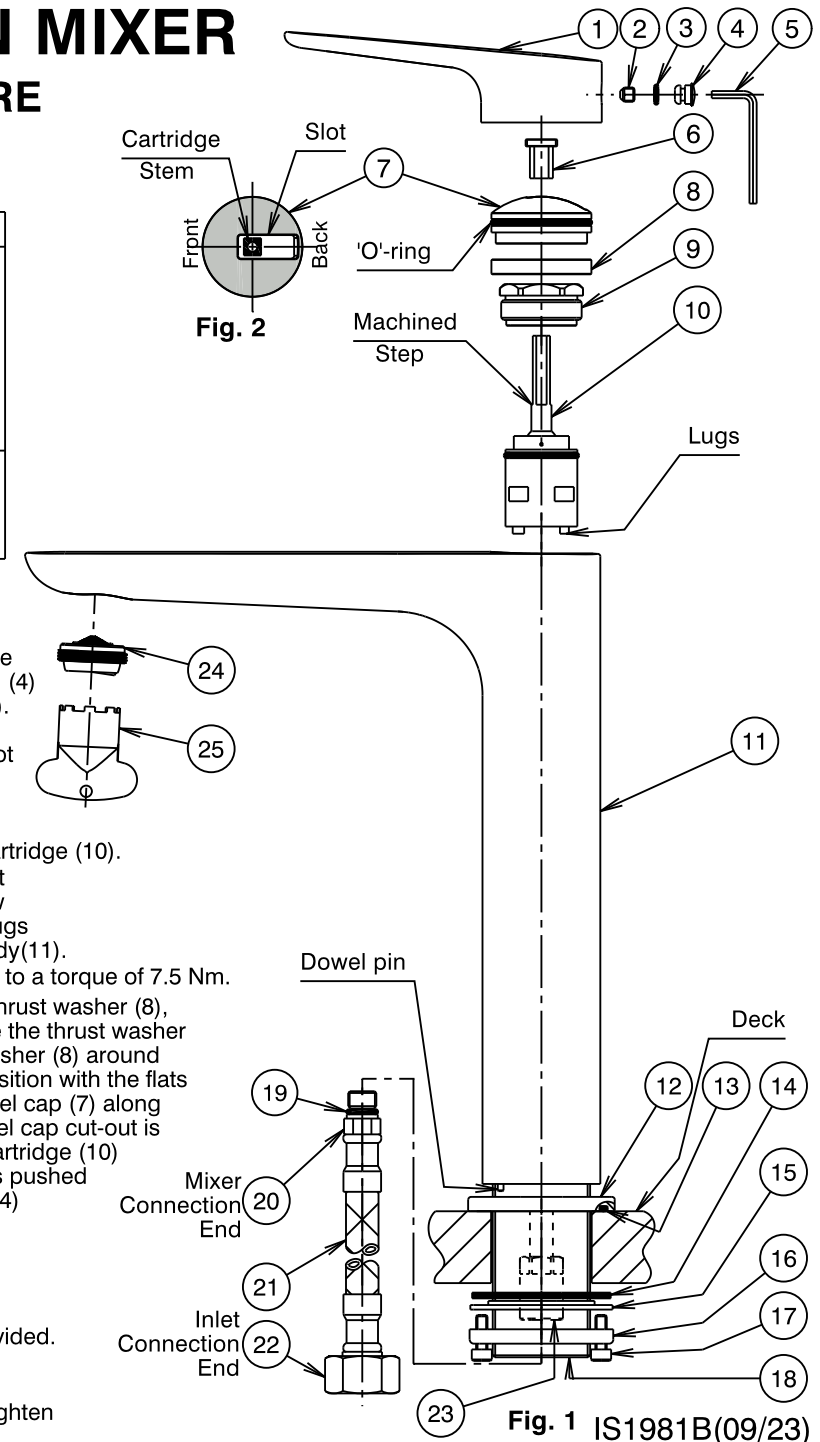

Fig. 1 IS1981B(09/23)